

AGGREGATE CHANGES			
Type of parking	Existing	Proposed	Difference
Residents' parking	24.6 metres (4 spaces)	24.6 metres (4 spaces)	0.0 metres (no change)
Single yellow lines (Mon-Sat 8.30am - 6.30pm)	0 metres	52.6 metres	+ 52.6 metres
Double yellow lines	236.6 metres	186.9 metres	- 49.7 metres
Loading restrictions ("at any time")	156.2 metres	150.3 metres	- 5.9 metres

KEY	
	RESIDENTS' BAY
	DOUBLE KERB MARKINGS "AT ANY TIME" LOADING RESTRICTIONS
	DOUBLE YELLOW MARKINGS NO WAITING, "AT ANY TIME"
	SINGLE YELLOW MARKINGS NO WAITING, MON-SAT 8:30AM-6:30PM

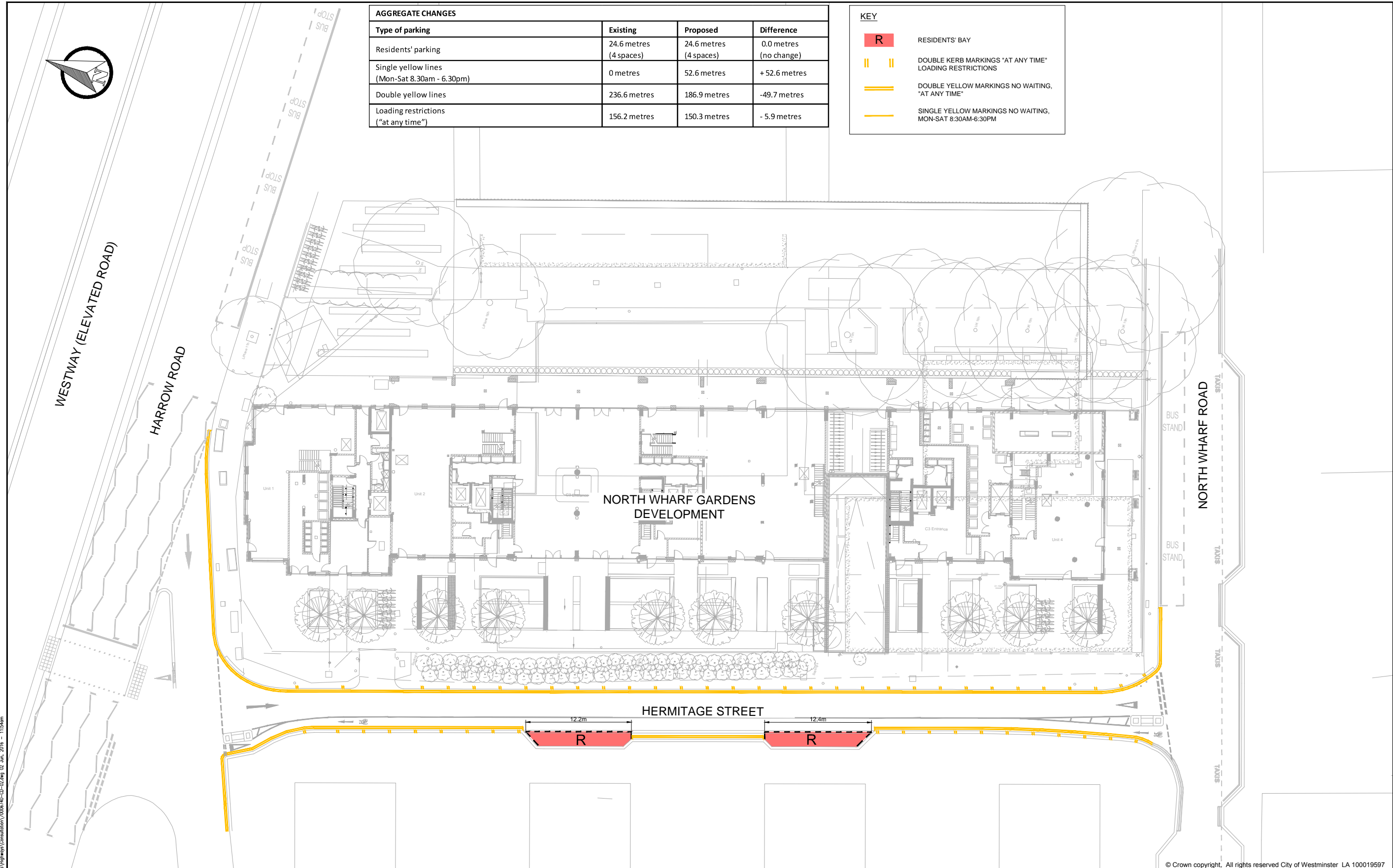

© Crown copyright. All rights reserved City of Westminster LA 100019597

NOTES:  
1. FOR PROPOSED PARKING/ LOADING RESTRICTIONS REFER TO DRAWING No. 70006740-CD-03.

REV	DATE	BY	DESCRIPTION	CHK	APD
C	02.06.2016	DW	CYCLE LANE ROAD MARKINGS ADDED	JB	JB
B	12.05.16	DW	MINOR AMENDMENTS	JB	JB
A	20.04.16	DW	INITIAL ISSUE	JB	JB

CLIENT:

DRAWING STATUS:		
<b>CONSULTATION</b>		
SCALES	1:200	ORIGINAL ISSUE SIGNATURES
FMC PROJECT NO	WWESA1239	DESIGNDRN D.WILLIAMS
BRIEF/DSB NO	TBA	CHECKED J.BALBOA
ORIGINAL SIZE	A1	APPROVED J.BALBOA
GRID	OS_DATA	© Copyright reserved

PROJECT:	
NORTH WHARF GARDENS	
TITLE:	TMO CONSULTATION EXISTING PARKING/ LOADING RESTRICTIONS

25 Mandela Way, London, SE1 5SZ  
www.fmcconway.co.uk www.wspgroup.com

DRAWING No: 70006740-CD-02

Rev. C

E:\70006740 - North Wharf Gardens\E Models and Drawings\Highways\Consultation\70006740-CD-02.dwg (2 Jun 2016 - 11:54am)